

## 2857862 - Load-bearing crossbar TPE15TM-1S

Cross arm type	E-pole
Pole distance	
Phase distance	1,5m
Pole fastening	280mm-single poleclamp

### Crossbar profile P1 (standing)

Weight: (kg/m)	3.857
Cross section: (mm <sup>2</sup> )	1428
Material:	Extruded aluminum, brown anodized
Alloy:	AlMgSi 6005A-T6
Moment of resistance: (mm <sup>3</sup> )	W <sub>x</sub> = 37 608 W <sub>y</sub> = 21 153
Area moment of inertia: (mm <sup>4</sup> )	I <sub>x</sub> = 2 049 632 I <sub>y</sub> = 645 852
Center distance for I <sub>x</sub> : (mm)	C <sub>x</sub> = 54,50
Center distance for I <sub>y</sub> : (mm)	C <sub>y</sub> = 30,53
Minimum yield strength 0,2: (N/mm <sup>2</sup> )	215
Minimum breaking load: (N/mm <sup>2</sup> )	255

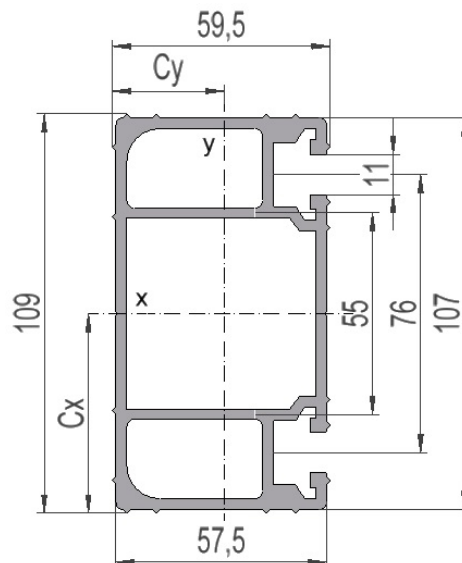

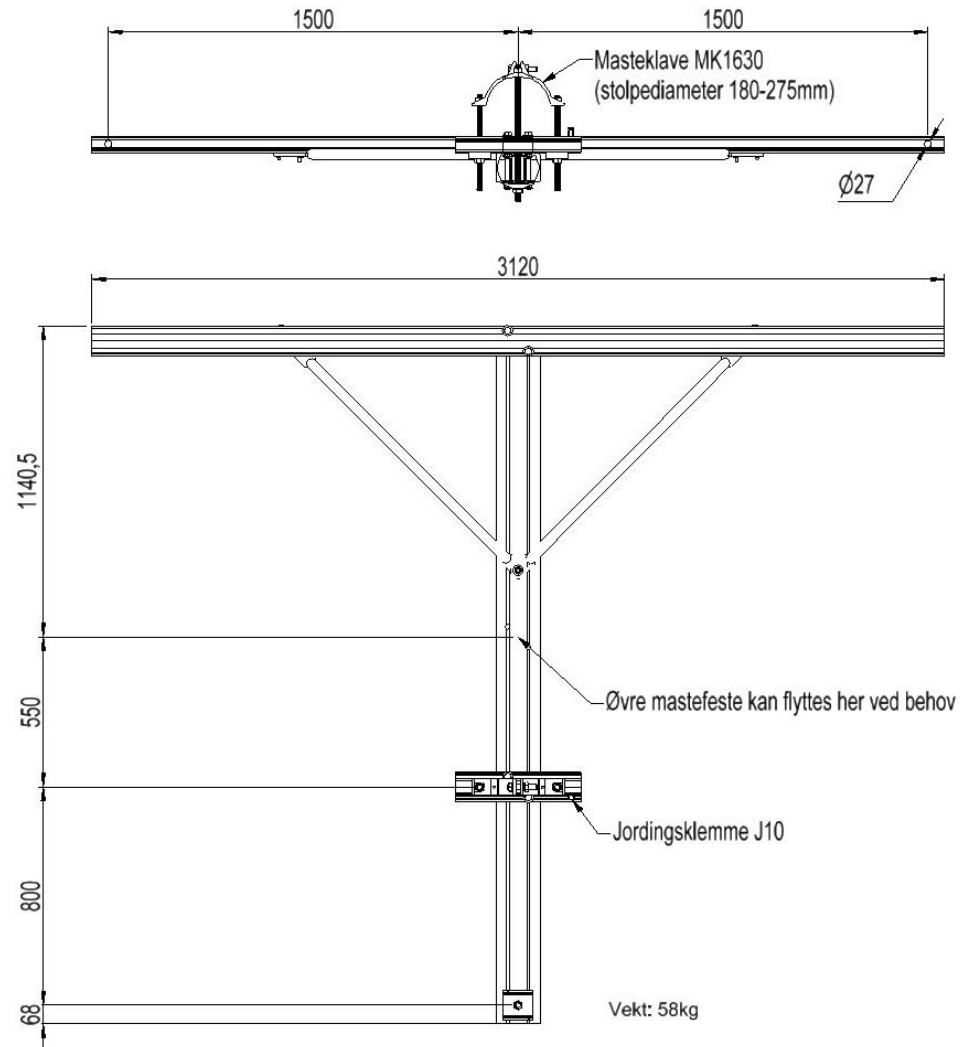

## Lastdiagram m.h.p flytegrense

(Bøyekrefter p.g.a piggisolatorer/støtteisolatorer er ikke medregnet)  
(tverrkrefter og skjevlast ikke medregnet)

Maks vertikal kraft ved bruk av  
treskrue i støttestag: 5 100N

